

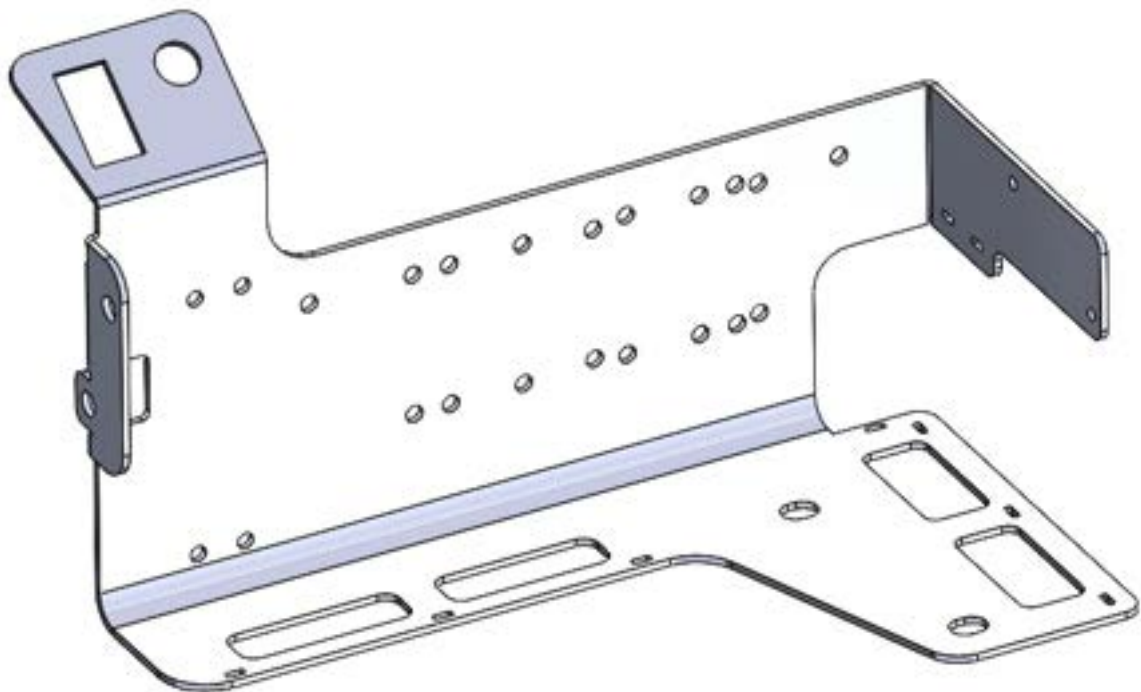

**COMPRESSOR BRACKET
SUITS TOYOTA TACOMA 2024 ON**

INSTALLATION GUIDE

3523060



No liability is assumed for damages resulting in the use of the information contained herein.

ARB Air Locker Air Operated Locking Differentials, ARB Air Locker Air Activation System and Air Locker are trademarks of ARB Corporation Limited.

Other product names used herein are for identification purposes only and may be trademarks of their respective owners.

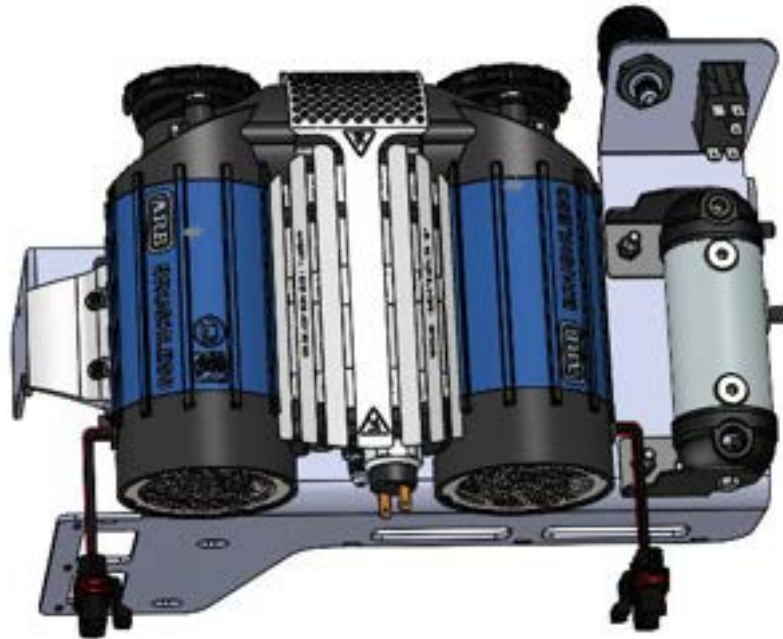

ARB 4x4 ACCESSORIES

Corporate Head Office

42-44 Garden St
Kilsyth, Victoria
AUSTRALIA
3137

Tel: +61 (3) 9761 6622

Australian enquiries
North and South American enquiries
Other international enquiries

sales@arb.com.au
sales@arbusa.com
exports@arb.com.au

www.arb.com.au

Table of Contents

1	Introduction	
1.1	Pre-Installation Preparation	4
1.2	Kit Description	4
1.3	Compatible Products.....	4
1.4	Kit Contents	5
1.5	Tool-Kit Recommendations	6
1.5.1	Tools.....	6
1.5.2	Supplies	6
2	Compressor Bracket Pre-Assembly	
2.1	Bracket Pre-Assembly for Single Compressors.....	7
2.2	Bracket Pre-Assembly for Brushed Twin Compressor.....	9
2.3	Bracket Pre-Assembly for Brushless Twin Compressor.....	11
2.4	Installing a Compressor Manifold Kit	13
3	Installation	
3.1	Installation of the Compressor Bracket Assembly	14
3.2	Brushed Compressor Harness Installation.....	18
3.3	Brushless Compressor Harness Installation	19
3.4	Post-Installation	20

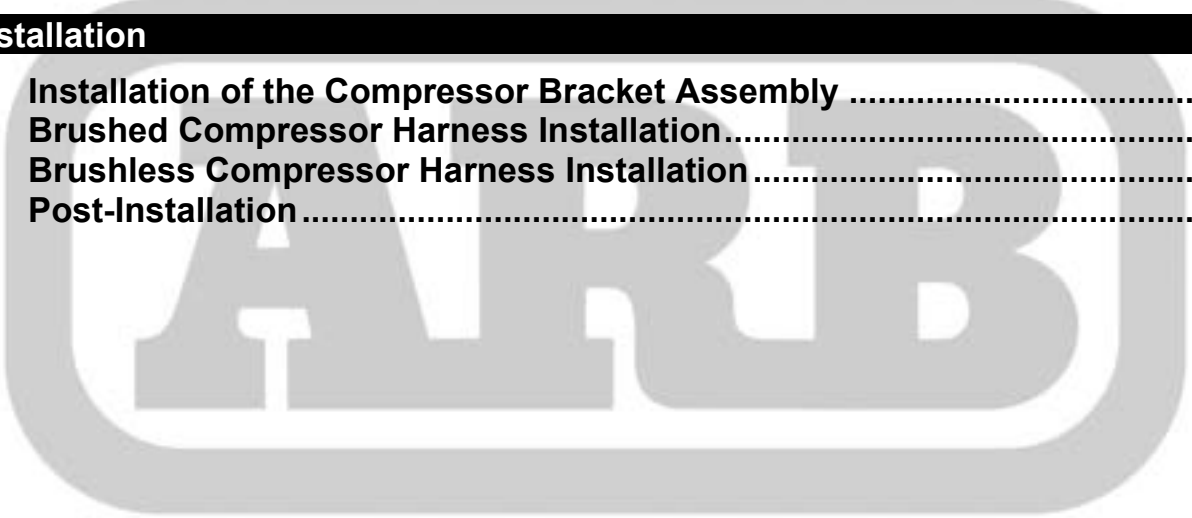

IMPORTANT:

To ensure the highest level of planning and reliability goes into this installation, please read this guide in its entirety before attempting any modifications to the vehicle.

1.1 Pre-Installation Preparation

Your ARB Air Compressor Bracket kit comes with comprehensive step by step instructions needed for installation. However, it is recommended that your ARB Air Compressor Bracket installation be performed by a qualified professional. ARB has trained distributors worldwide to ensure a class leading and proficient installation process that won't let you down!

To ensure a smooth and efficient installation, please verify that the Air Compressor Bracket kit is compatible with your specific application and includes all required components listed in Section 1.4. Additionally, ensure that you have acquired the necessary tools, parts, and materials for the installation process as outlined in Section 1.5.

For comprehensive information on operating, servicing, and troubleshooting your ARB Compressor and/or Air Locker(s), please consult your ARB Compressor and Air Locker Operating & Service Manuals.

HINT: Place a ✓ mark inside each of the symbols as you complete each step. It is very important NOT to miss any of the steps!

1.2 Kit Description

The Tacoma Compressor Bracket allows you to install an ARB Single or Twin Compressor (Including ARB Brushless Compressors)

1.3 Compatible Products

- CKBLA – Brushless Single On-Board Compressor
- CKBLTA – Brushless Twin On-Board Compressor
- CKMTA – Brushed Single On-Board Compressor
- CKMA – Brushed Twin On-Board Compressor
- CKSA - Compact On-board (Single) Compressor
- ARB Air Lockers (including Solenoid Kits)
- 171319 Air Filter Relocation Kit - 2x kits required when used with the CKMTA
- 171503 Compressor Manifold Kit

1 Introduction

1.4 Kit Contents

- 1 x 37500599 COMP BRACKET TACOMA 24ON
- 1 x 6178527 F/KIT 3523060 TACOMA 24ON
 - 1 x 0740111 HOSE COUPLING US STD JIC-4
 - 1 x 0740203 HOSE REINFORCED 1 MTR
 - 1 x 180226 SWITCH BLANKING PLATE
 - 25 x 180302 CABLE TIE 4.8x180 mm
 - 2 x 4581075 WASHER FLAT M8
 - 8 x 4584327 WASHER FLAT M6x16x1.2
 - 2 x 4584347 WASHER FLAT M5
 - 1 x 4584399 WASHER FLAT M10x25x3
 - 4 x 6151223 NUT HEX M6x1.0 NYLON LOCKING
 - 4 x 6151560 BOLT HXHD M6x1.0x16
 - 2 x 6151608 NUT M5 NYLON LOCKING
 - 2 x 6151650 SCREW BHD M5x20
 - 2 x 6152278 BOLT HXHD M8x1.25x16 NYLON LOCKING
 - 1 x 6821242 CABLE TIE HOLDER 19x19 mm BLACK

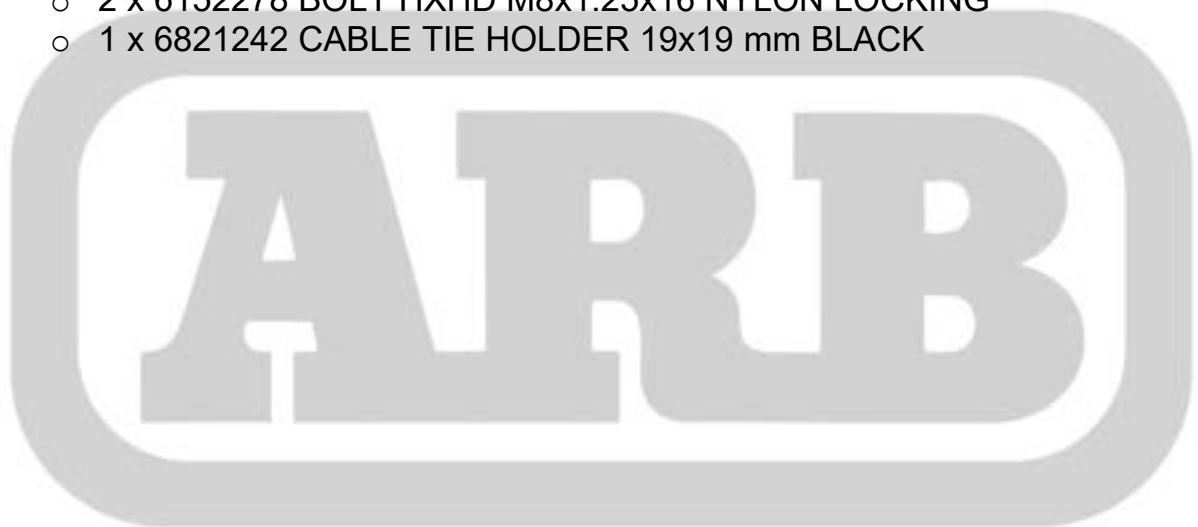

1 Introduction

1.5 Tool-Kit Recommendations

Below is a list of tools and supplies recommended to complete this installation.

1.5.1 Tools

- Standard automotive sizes (metric and/or imperial) of sockets, wrenches, Allen keys, power drill/driver, No.2 Phillips and T30 Torx bits, Torque Wrench 5-20 Nm range
- Razor knife to cut rubber hose
- Leak test gauge (i.e., ARB# ALTG01)
- Multimeter
- Soldering iron

1.5.2 Supplies

- Thread lubricant/sealant compound for pressure fittings (e.g., LOCTITE #567 Teflon paste or plumbing supply Teflon tape)
- Soapy water mixture to test for air leaks
- Electrical tape/heat shrink
- Solder and/or automotive crimp fittings

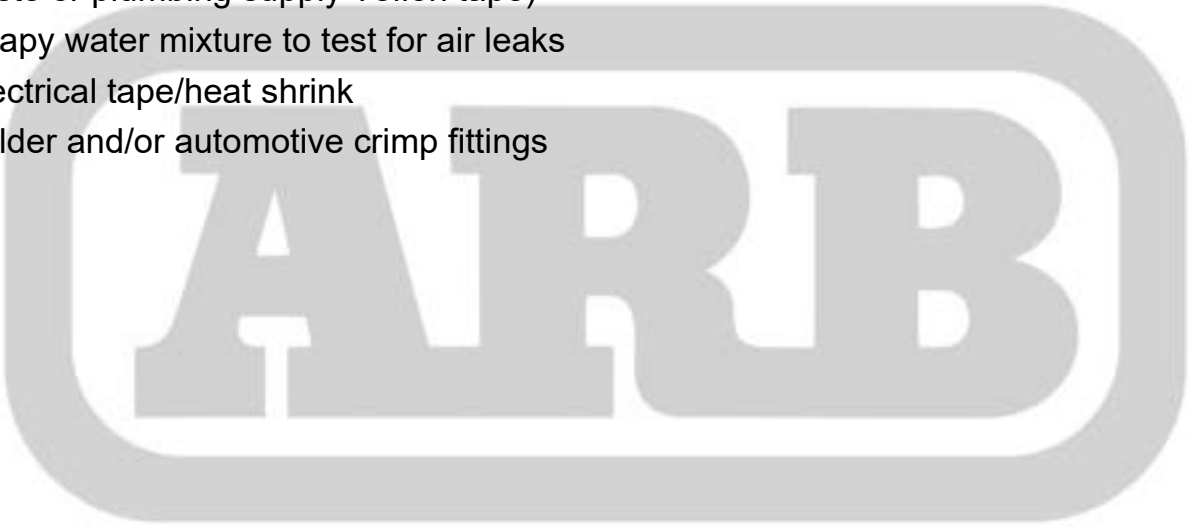

2 Compressor Bracket Pre-Assembly

NOTE: Sealant is not required for JIC fittings.



Figure 1. No sealant is required on JIC fittings or parallel threads

2.1 Bracket Pre-Assembly for Single Compressors

This section applies to both brushed and brushless single compressors.

A manufacturer's service manual and ARB Operation & Installation manuals should be used in conjunction with these instructions.

NOTE: Sealant is not required for JIC fittings. See Figure 1

- Use the M6 fasteners supplied in this kit and your compressor kit as shown below to connect the two brackets in the assembly.

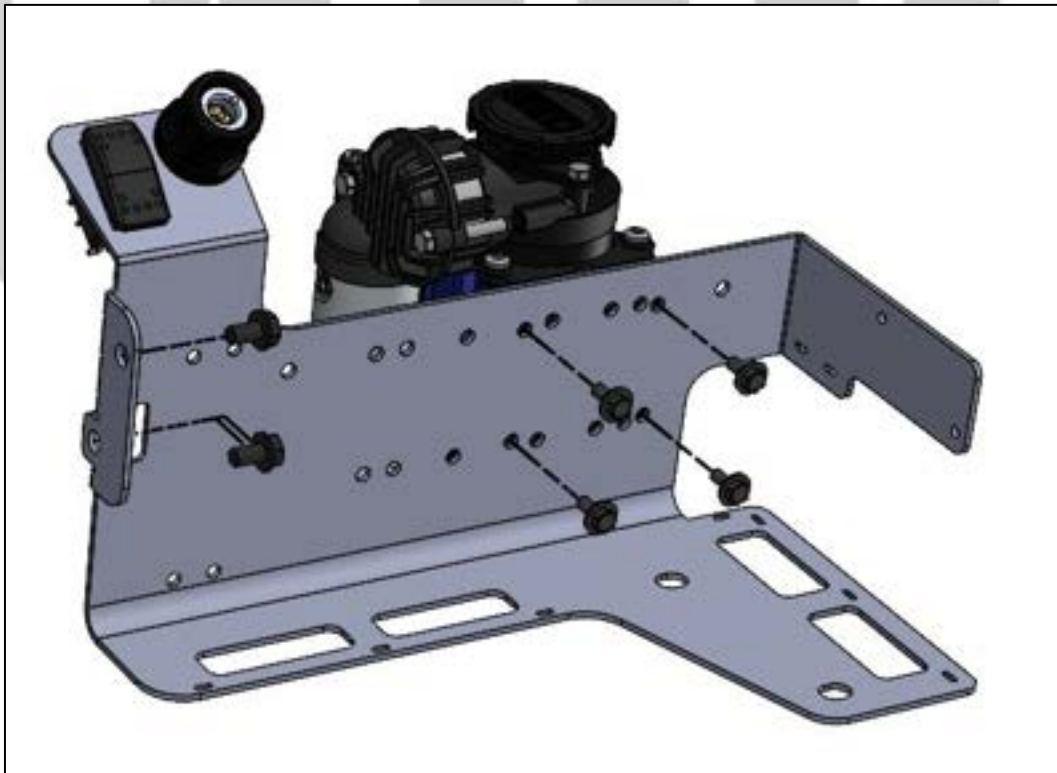

Figure 2. Single Compressor bracket pre-assembly front view

2 Compressor Bracket Pre-Assembly

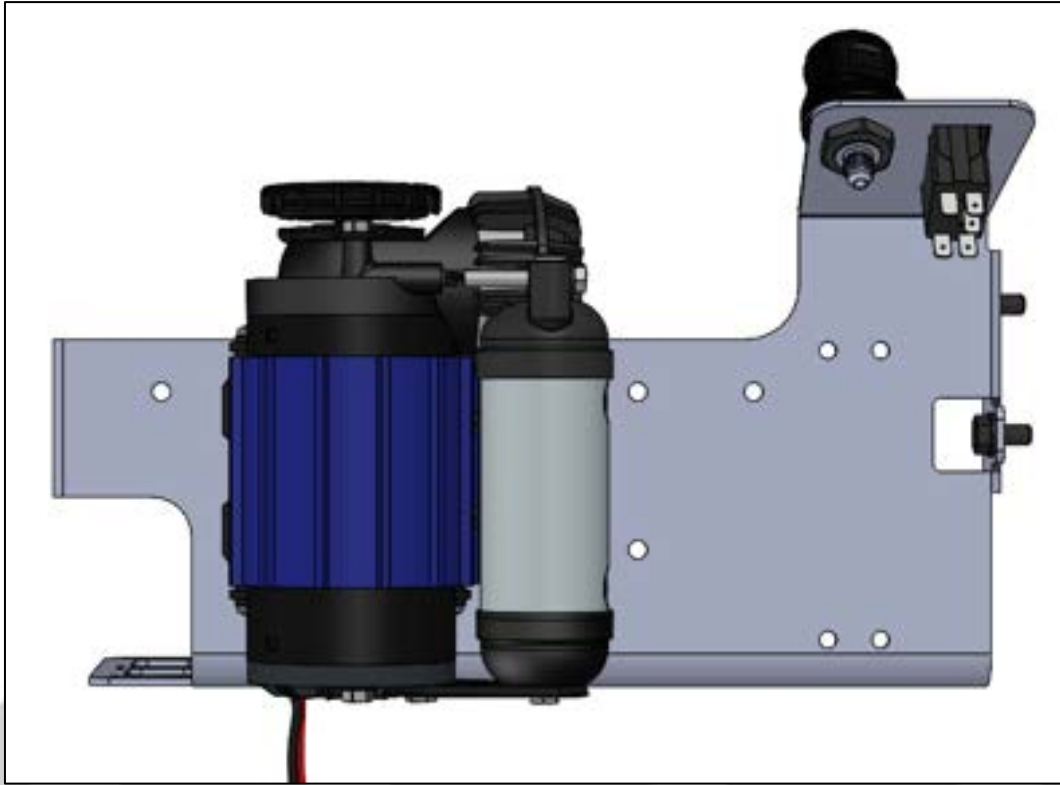
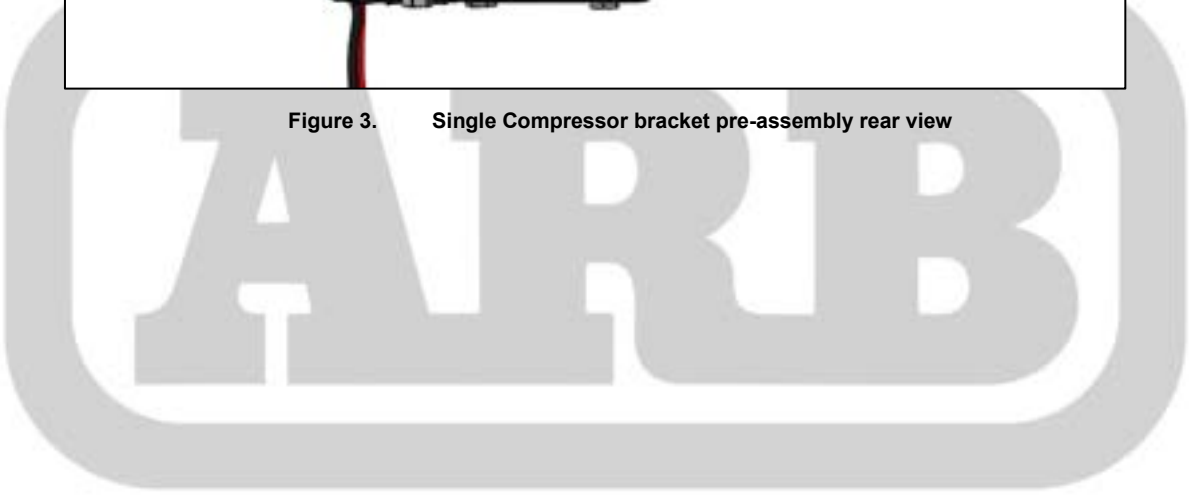

Figure 3. Single Compressor bracket pre-assembly rear view



2 Compressor Bracket Pre-Assembly

2.2 Bracket Pre-Assembly for Brushed Twin Compressor

- Secure the compressor to the bracket using the included M6 fasteners and the hole pattern shown in Figure 4 and Figure 5.

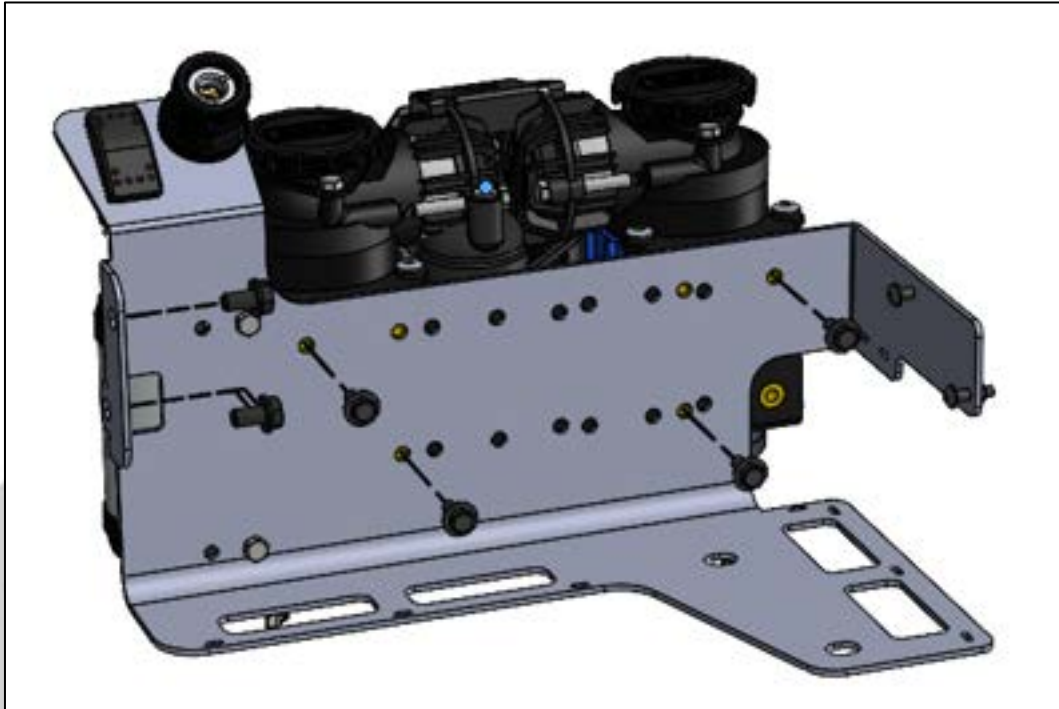

Figure 4. Brushed Twin Compressor bracket pre-assembly front view

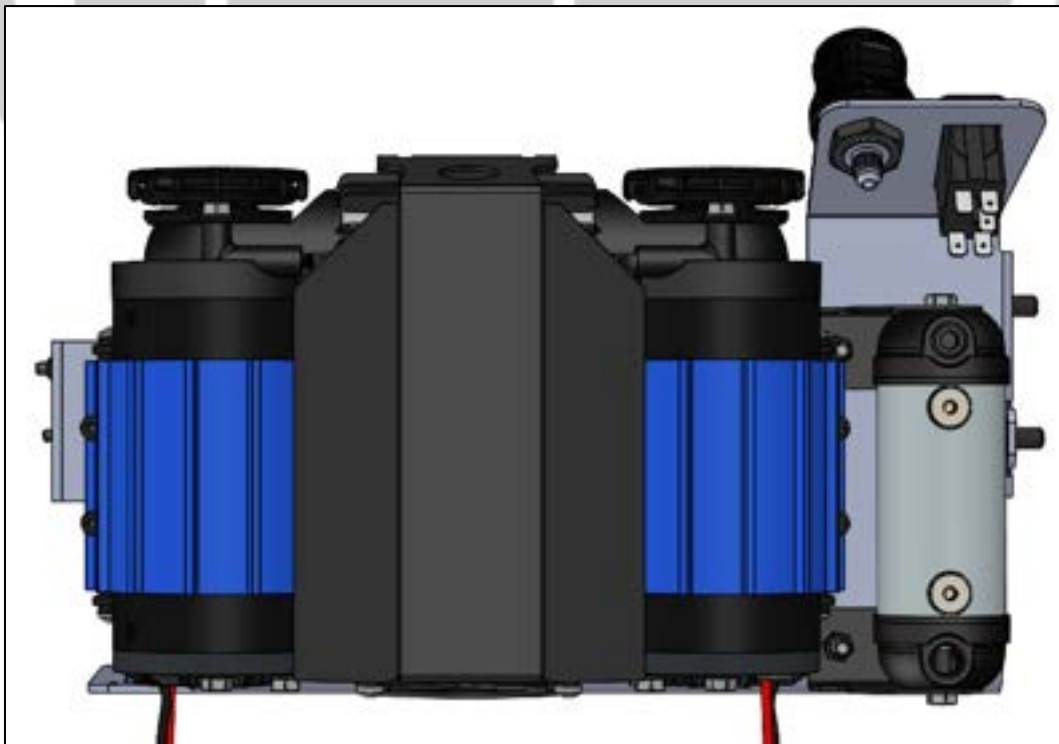

Figure 5. Brushed Twin Compressor bracket pre-assembly rear view

2 Compressor Bracket Pre-Assembly

- Remove the central compressor cover by removing 4 x M6 fasteners and disconnecting 2 x electrical terminals. This will allow fitment of the reinforced air line.

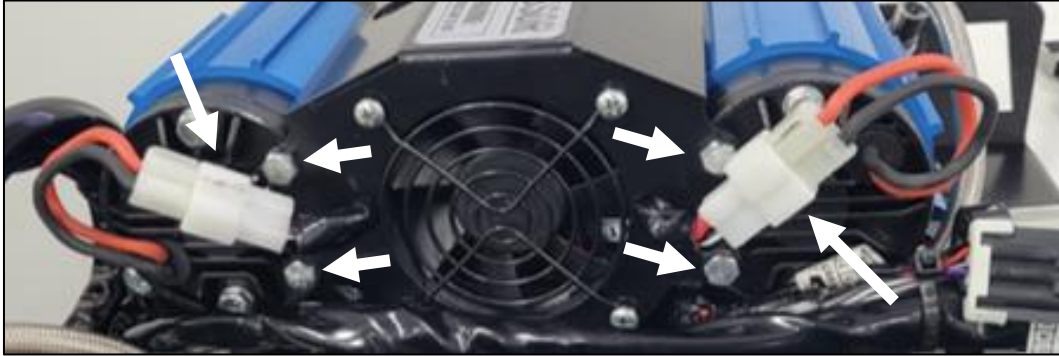

Figure 6. Remove fasteners and disconnect harness

- Install reinforced air line as shown below.



Figure 7. Positioning of the reinforced air line by manifold cap rotation

- Replace the compressor cover.
- Install the wiring harness.
- Carefully bundle the wiring harness and reinforced air line and cable tie as shown in Figure 8 and Figure 9.

NOTE: Take care to align all holes and torque M6 fasteners to 9 Nm (7 lb.ft).

2 Compressor Bracket Pre-Assembly



Figure 8. Retention of air line and harness with cable ties



Figure 9. Compressor bracket assembly ready for installation into a vehicle

2.3 Bracket Pre-Assembly for Brushless Twin Compressor

- Secure the compressor to the bracket using the included M6 fasteners and the hole pattern shown in Figure 10.
- Refer to the respective compressor manual to adjust the compressor height. Align the top of the blue motor tubes with the top edge of the bracket as shown in Figure 11.

NOTE: Take care to align all holes and torque M6 fasteners to 9 Nm (7 lb.ft).

2 Compressor Bracket Pre-Assembly

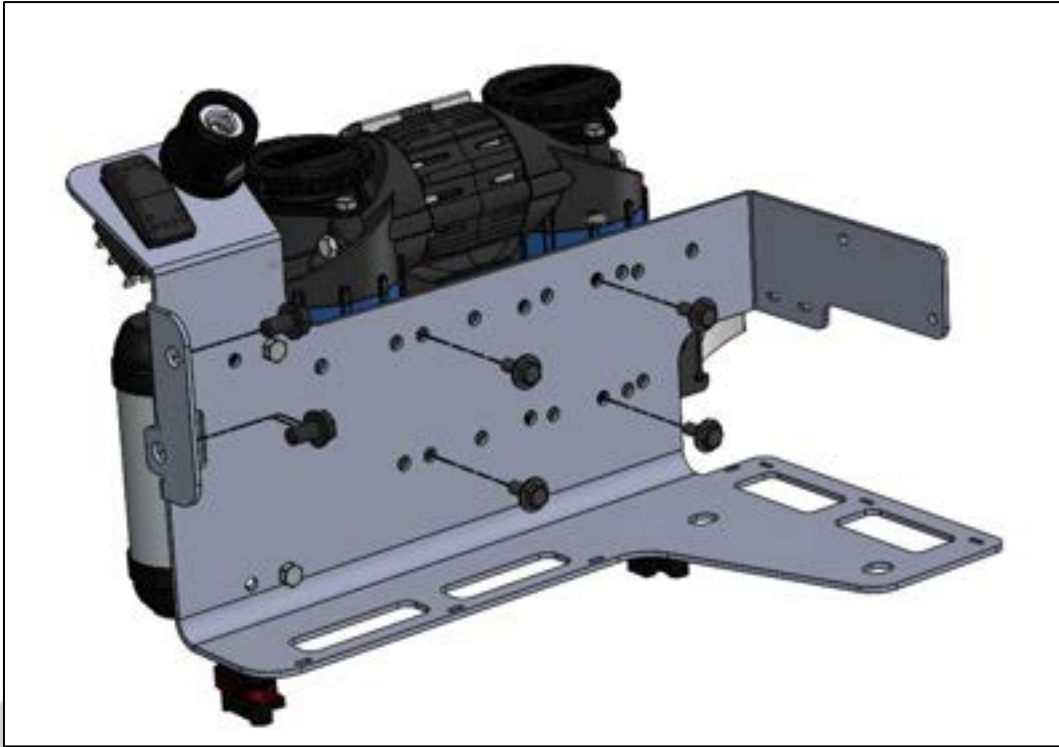

Figure 10. Brushless Twin Compressor bracket pre-assembly front view

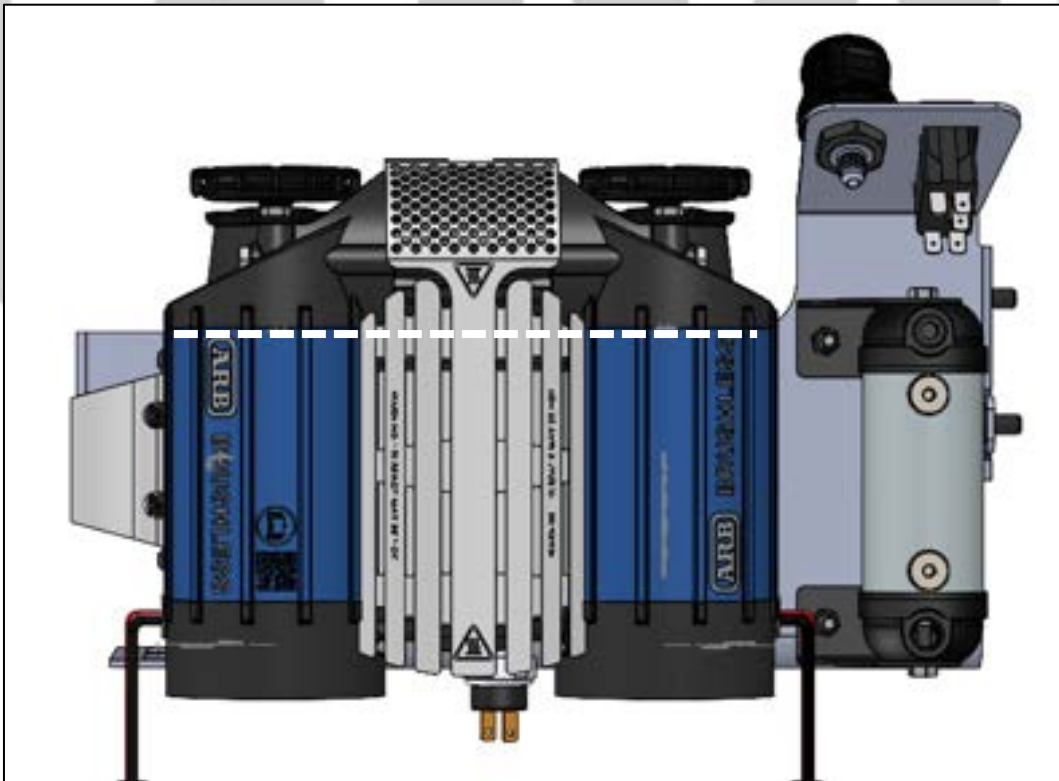

Figure 11. Brushless Twin Compressor bracket pre-assembly rear view

2 Compressor Bracket Pre-Assembly

2.4 Installing a Compressor Manifold Kit

- Install the kit as illustrated in Figure 12 using the two M6 fasteners provided.
- Install reinforced air lines as your application requires.

NOTE: Sealant is not required for JIC fittings. See Figure 1

NOTE: ARB Compressors are not supplied with the manifold kit (PN 171503). Accessories that mount onto the manifold are available separately.

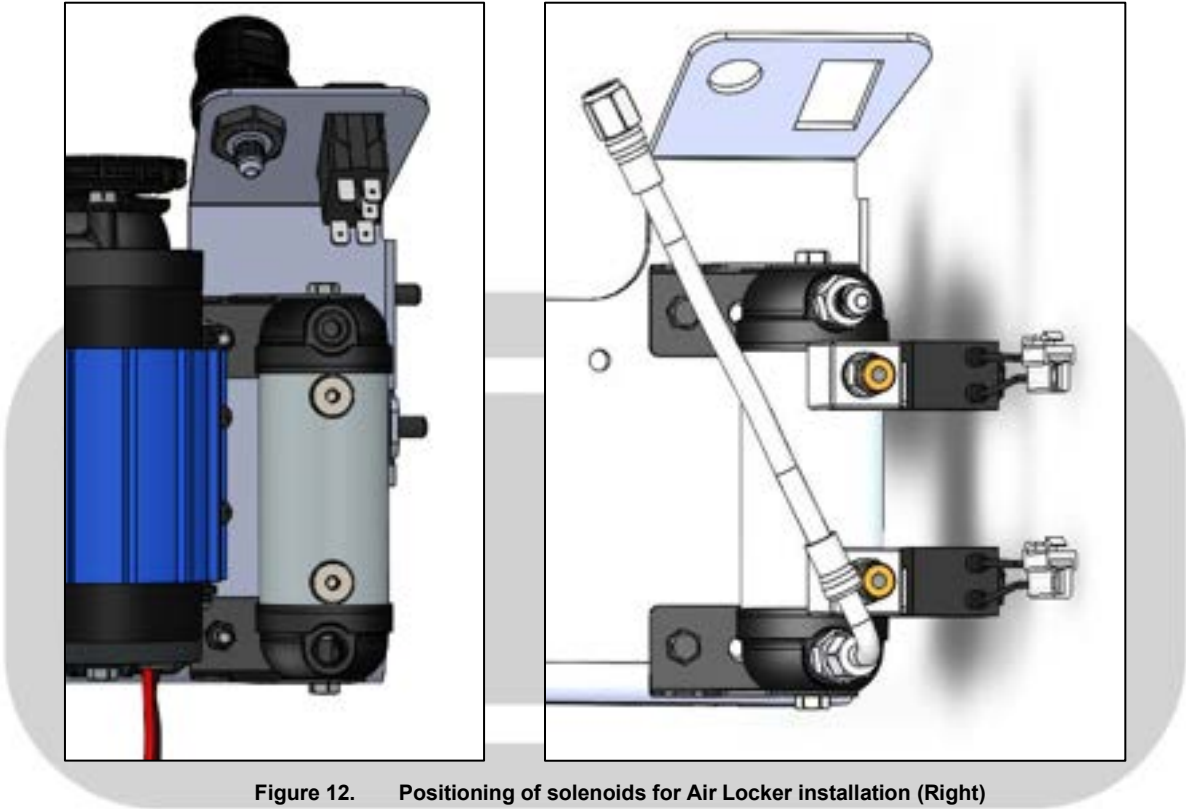

Figure 12. Positioning of solenoids for Air Locker installation (Right)

3 Installation

3.1 Installation of the Compressor Bracket Assembly

- Remove the battery and battery tray fasteners as illustrated below, retaining the original fasteners for re-assembly.



Figure 13. Battery tray and original fasteners

- Unscrew the plastic scrivet from the apron cover as shown in Figure 14, retaining the scrivet for re-assembly.

3 Installation



Figure 14. Scrivet location

- Gently lever up the apron cover and remove it. Retain the apron cover for re-assembly.



Figure 15. Location of apron cover retainers

- Remove the cable retainer circled in Figure 16 and discard it.
- Install the included adhesive cable tie retainer in the position shown in Figure 16. Clean the surface prior to installation.

3 Installation



Figure 16. Original cable retainer and replacement adhesive cable tie retainer

- Install the compressor assembly, ensuring to place the M10x3 mm washer in the location shown in Figure 17.



Figure 17. Compressor bracket assembly spacer washer

3 Installation

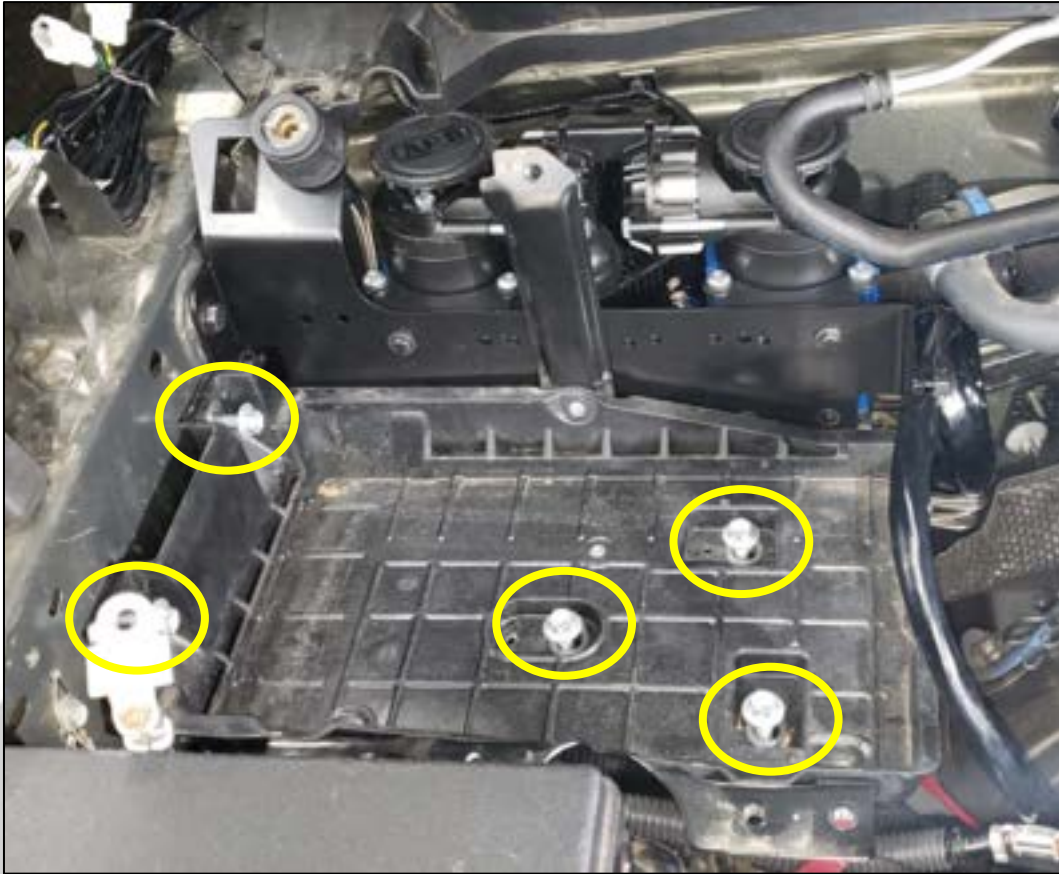

Figure 18. Battery tray and original fasteners

3 Installation

3.2 Brushed Compressor Harness Installation

- Install the positive cable/cables to the positive terminal of the battery.
- Securely attach the fuses to a suitable anchor point with cable ties. A preferred location is shown in Figure 19.
- Install the ground cable to a suitable grounding point on the vehicle ensuring all grounding surfaces are clean and paint is removed. Factory grounding points are the preferred option. A nearby location is shown in Figure 21.



Figure 19. Brushed Compressor harness fuse location

3 Installation

3.3 Brushless Compressor Harness Installation

- Install the single/twin Midi fuse holder and positive cable in the location provided using two M5 screws.



Figure 20. Brushless Compressor harness fuse location

- Install the negative cable to a suitable grounding point on the vehicle ensuring all grounding surfaces are clean and paint is removed. Factory grounding points are the preferred option as shown below.



Figure 21. Preferred body grounding point

3 Installation

3.4 Post-Installation

Test your compressor installation according to its installation guide.

The Troubleshooting sections in the compressor guides are still applicable to this bracket installation.

