



# FITTING INSTRUCTIONS

Part Number: 3550130  
 Product RADAR INSTALL KIT  
 Description:  
 Suited to  
 vehicle/s: JEEP GRAND CHEROKEE WK2 2018 ON

## ARB 4x4 ACCESSORIES

### Corporate Head Office

42-44 Garden St  
 Kilsyth, Victoria  
 AUSTRALIA 3137

Tel: +61 (3) 9761 6622  
 Fax: +61 (3) 9761 6807

Australian enquiries  
 North & South American enquiries  
 Other international enquiries

sales@arb.com.au  
 sales@arb.com.au  
 exports@arb.com.au

[www.arb.com.au](http://www.arb.com.au)

### FITTING REQUIREMENTS

#### REQUIRED TOOLS FOR FITMENT OF PRODUCT:

BASIC TOOL KIT

#### HAVE AVAILABLE THESE SAFETY ITEMS WHEN FITTING PRODUCT:

Protective eyewear



Hearing protection



**NOTE: 'WARNING' notes in the fitting procedure relate to OHS situations, where to avoid a potentially hazardous situation it is suggested that protective safety gear be worn or a safe work procedure be employed. If these notes and warnings are not heeded, injury may result.**

#### FASTENER TORQUE SETTINGS:

| SIZE       | Torque Nm | Torque lbft |
|------------|-----------|-------------|
| M6         | 9Nm       | 7lbft       |
| M8         | 22Nm      | 16lbft      |
| M10        | 44Nm      | 32lbft      |
| M12 x1.75  | 77Nm      | 57lbft      |
| M12 x 1.25 | 96Nm      | 71lbft      |

| <b>PARTS LISTING</b> |                 |            |                                     |
|----------------------|-----------------|------------|-------------------------------------|
| <b>APPLICATION.</b>  | <b>PART NO.</b> | <b>QTY</b> | <b>DESCRIPTION</b>                  |
|                      | 3750446         | 1          | BRKT MT RADAR WK2 MY18              |
|                      | 6151213         | 5          | BOLT M6 x 1.0 x 20 Gd8.8 BZ         |
|                      | 4581287         | 5          | WASHER SPRING M6 x 2.5 x 1.6 BLK ZN |
|                      | 4584295         | 3          | WASHER FLAT M6 X 12 X 1.3 BLK ZN    |
|                      | 6151128         | 3          | NUT FLANGE M6 x 1.0 ZP              |
|                      | 6151315         | 4          | NUT CAGED M6 0.7-1.6                |
|                      | 4581082         | 2          | WASHER FLAT, M6 x 19 x 1.6 BZ       |
|                      | 6151443         | 2          | SCREW BTN HD M6 x 20 BZ             |
|                      | 180302          | 6          | CABLE TIE 4.8 X 180 MM BLACK        |
|                      | 6523238         | 1          | PANEL RADAR SURROUND WK2 MY18       |
|                      | 3750445         | 2          | BRKT MT RADAR COVER WK2 MY18        |
|                      | 2125570         | 1          | WARNING CARD RADAR JEEP WK2         |

## FITTING PROCEDURE



1. Remove the radar and mounting plate from the vehicle.



2. Remove the rubber seal from the front by unclipping the 4 side tabs.

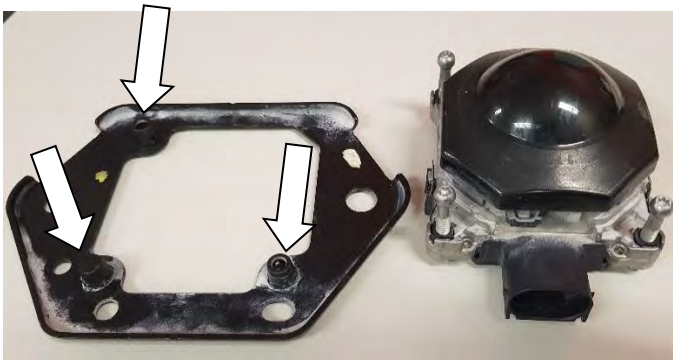

3. Gently pry the radar free of the plastic clips in the mounting plate. Remove the 3 plastic clips from the plate and put aside for later use.



4. Remove the 3 Torx drive ball screws from the radar and refit from the back side. Leave approx. 3 turns of thread visible on the screw. **Do not** bottoming out the bolt into the plastic thread.



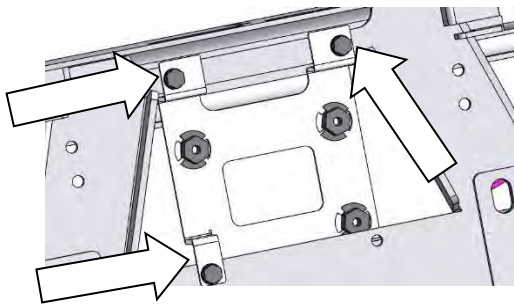

5. Attach the bracket to the bar from the rear as shown using M6 x 20 hex bolts, spring washers, flat washers and flange nuts.

Tighten the fasteners to the specified torque.

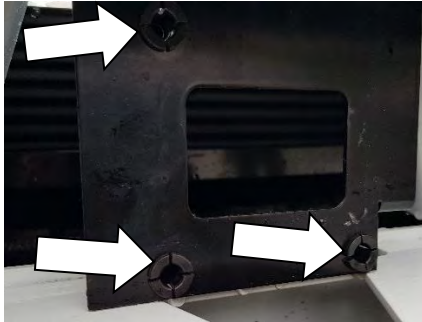
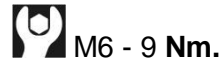

6. Take the plastic clips from step 3. Push them into the 3 holes in the new radar mount from the front of the bull bar.

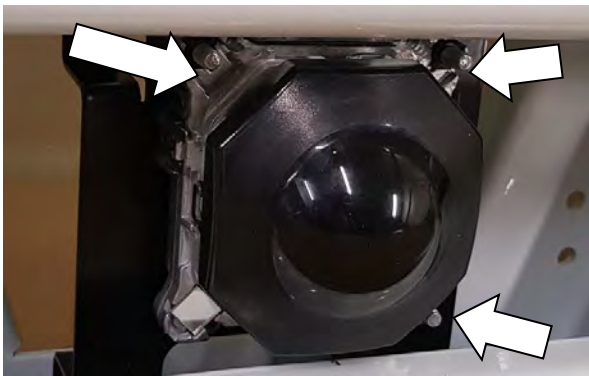

7. Carefully push the radar sensor into the plastic clips ensuring that they all clip in firmly.

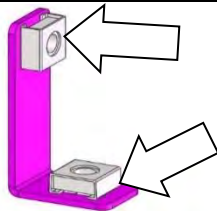

8. Fit 2 x caged nuts to each of the panel brackets as shown.

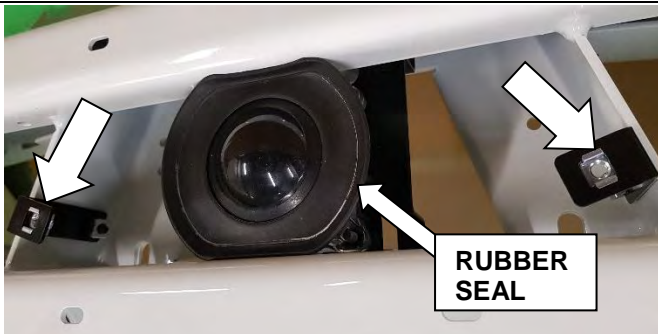

9. Using 2 x M6 bolts with spring and flat washers to attach the 90 Deg mount brackets to the bar.

10. Clip the rubber seal back onto the radar.



11. Fit the panel over the radar sensor and attach to the panel brackets using 2 x M6 button head cap screws.

Tighten the fasteners to the specified torque.



***Return to the bull bar fitting instructions.***