



FK111 FORD BRONCO

REAR STRUT SHIM KIT

- Allows vehicle shimming by 8mm at the wheel
- Limit 2 per side

KIT CONTENTS

Part No.	Description	Qty	Picture
3195466	PLATE SPACER REAR STRUT	4	
6151856	NUT FLANGE M10x1.5	6	

FITMENT PROCEDURE – REAR STRUT SHIM KIT

1. REMOVE STRUT FROM REAR OF VEHICLE

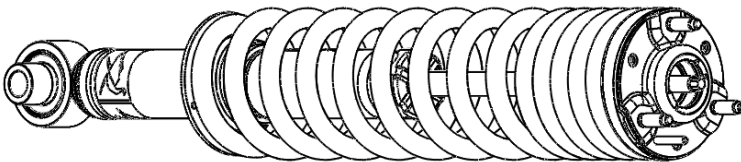

2. ADD APPROPRIATE NUMBER OF SHIMS (3195466) TO ACHIEVE CORRECT RIDE HEIGHT

- 1 SHIM = 4MM AT WHEEL
- 2 SHIMS = 8MM AT WHEEL

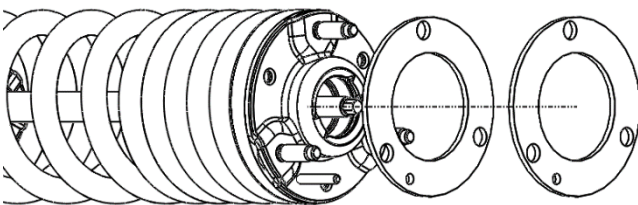

IMPORTANT NOTE

SHIMS MUST BE FITTED ON TOP OF STRUT ASSEMBLY, NOT BETWEEN ISOLATOR AND TOP HAT

3. REFIT TO VEHICLE AND USE M10X1.5 NUT (6151856) TO INSTALL.

APPLICATION OF LOCTITE (OR SIMILAR) IS RECOMMENDED. TORQUE TO 55Nm (40 ft-lb)
NOTE: TORQUE SPECS MAY CHANGE – CHECK WORKSHOP MANUAL

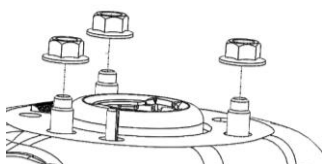

IMPORTANT NOTE

DO NOT USE MORE THAN 2 SHIMS PER STRUT
DO NOT USE ON FRONT STRUT